

Time Preset Counters – HVa 15



- 5-digit presettable hour meter
- Manual reset
- High shock resistance
- Magnified figures
- Protection IP 42 (front)
- Data retention if power is lost
- Long service life

Applications:

general counting, service interval for measurement systems (respiratory ventilators, oxygen machines, dialysis machines), small appliances, UV lamps, display panels in cars.

Technical data:

Electrical connection:	tin-plated round pins \varnothing 1.6 mm [0.063"], with push on connectors	
Power consumption:	10 ... 30 V DC:	approx. 0.5 W
	36 ... 80 V DC:	approx. 0.9 W
	100 ... 130 V DC:	approx. 0.75 W
	20 ... 30 V AC, 50 Hz:	approx. 0.3 VA
	42 ... 48 V AC, 50 Hz:	approx. 0.25 VA
	100 ... 130 V AC, 50 Hz:	approx. 0.6 VA
Rated voltages:	187 ... 264 V AC, 50Hz:	approx. 1.2 VA
	360 ... 440 V AC, 50Hz:	approx. 1.65 VA
	20 ... 30/42 ... 48/100 ... 130/187 ... 264, 360 V AC	
	50 or 60 Hz, 10 ... 30/36 ... 80/100 ... 130 V DC	
Range:	at AC: 999.99 h at DC: 9999.9 h	
On time:	100 %	
Count mode:	adding	
Colour of figures:	hour:	white on black,
	1/10 and 1/100 h:	red on white
	preset:	app. 4mm [0.158"] high
	Hour:	yellow on black
Reset:	1/10 and 1/100 h:	red on white
	manual	
Ambient temperature:	-15 ... +50 °C [5 ... 122 °F]	
Mounting position:	any	
Protection:	IP 42 front side,	
	sealing cover K1: IP 54 front side clear cover Dv and Dvs: IP 55 front side	

Colour of housing:	black, grey on request	
Switching contact:	1 changeover contact (Micro switch)	
	release at the preset time	
	loading capacity at AC: max.250 V, max 2 A	
	loading capacity at DC (ohmic load):	
	24 V max. 2.0 A	
	60 V max. 0.7 A	
	115 V max. 0.4 A	
	230 V max. 0.2 A	
	with inductive load, a spark quenching is required reducing the max. current to 65 %	
Options:	knob-locking 0-reset	
Housing:	black: Art. no.	3.30X.X17.XXX
	grey: Art. no.	3.30X.X16.XXX
	HVa 15.01 (without front bezel)	
	pluggable in socket box 946.1	
	DIN Rail mount SR 3	
Housing:	black: Art. no.	3.300.001.XXX
	beige: Art. no.	3.300.012.XXX
Test voltage:	2000 V AC, 50 Hz for AC	
Sealing:	oil and gasoline-resistant synthetic rubber, particularly suitable for use with acids and alkalis, very good age stability.	
Accessories:	socket box 946.1	Art. no. G.008.439
Front frame:	black:	Art. no. G.007.504
	beige:	Art. no. G.007.503

HVa 15.11

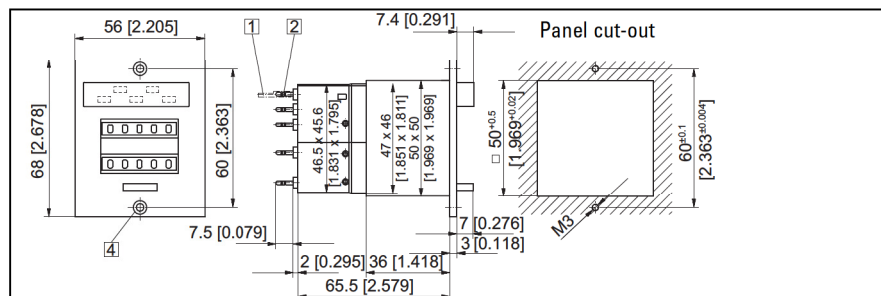

Voltage	Art-No. (AC), 50 Hz	Art-No. (AC), 60 Hz	Art-No. (V DC)
10 ... 30			3.300.111.351
20 ... 30	3.300.111.071	3.300.111.081	
36 ... 80			3.300.111.353
42 ... 48	3.300.111.072	3.300.111.082	
100 ... 130	3.300.111.074	3.300.111.084	3.300.111.381
187 ... 264	3.300.111.075	3.300.111.085	
360 ... 440	3.300.111.079	3.300.111.089	

- 1 Tin plated push on connector
- 2 Round pin \varnothing 1.5 [0.059"] tin plated
- 4 Countersunk Af34 DIN 74

Time Preset Counters – HVa 15

HVa 15.21

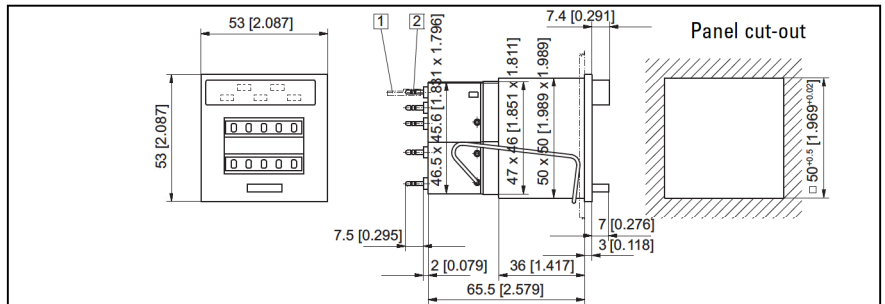

Voltage	Art-No. (AC), 50 Hz	Art-No. (AC), 60 Hz	Art-No. (V DC)
10 ... 30			3.300.211.351
20 ... 30	3.300.211.071	3.300.211.081	
36 ... 80			3.300.211.353
42 ... 48	3.300.211.072	3.300.211.082	
100 ... 130	3.300.211.074	3.300.211.084	3.300.211.381
187 ... 264	3.300.211.075	3.300.211.085	
360 ... 440	3.300.211.079	3.300.211.089	

- 1 Tin plated push on connector \varnothing 1.5 [0.059"]
- 2 Tin plated round pin \varnothing 1.5 [0.059"]

HVa 15.31

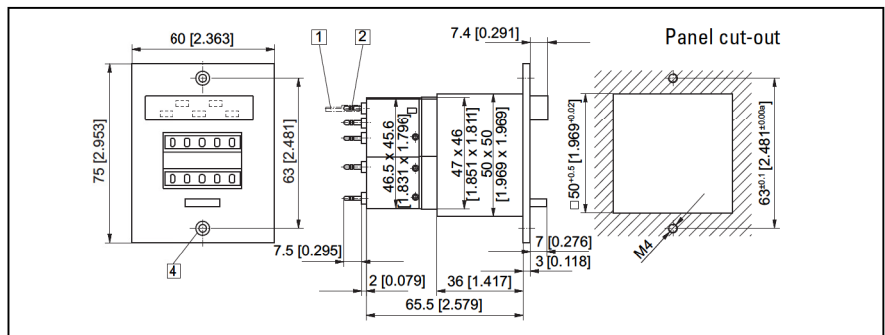

Voltage	Art-No. (AC), 50 Hz	Art-No. (AC), 60 Hz	Art-No. (V DC)
10 ... 30			3.300.311.351
20 ... 30	3.300.311.071	3.300.311.081	
36 ... 80			3.300.311.353
42 ... 48	3.300.311.072	3.300.311.082	
100 ... 130	3.300.311.074	3.300.311.084	3.300.311.381
187 ... 264	3.300.311.075	3.300.311.085	
360 ... 440	3.300.311.079	3.300.311.089	

- 1 Tin plated push on connector \varnothing 1.5 [0.059"]
- 2 Tin plated round pin \varnothing 1.5 [0.059"]
- 4 Countersunk Af3 DIN 74

K2 HVa 15.31

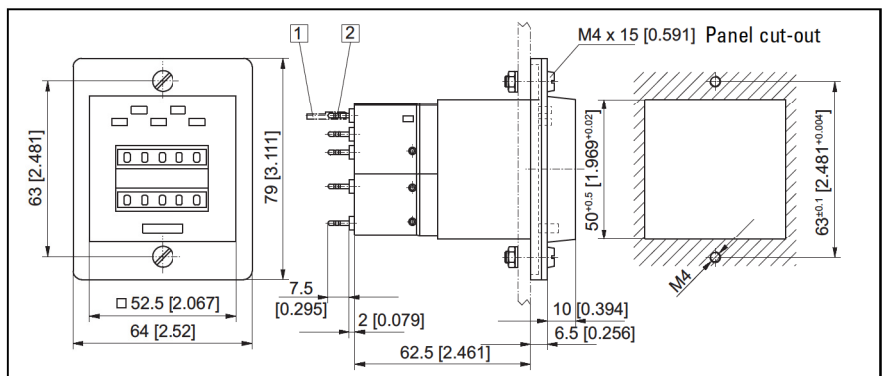

Voltage	Art-No. (AC), 50 Hz	Art-No. (AC), 60 Hz	Art-No. (V DC)
10 ... 30			3.300.611.351
20 ... 30	3.300.611.071	3.300.611.081	
36 ... 80			3.300.611.353
42 ... 48	3.300.611.072	3.300.611.082	
100 ... 130	3.300.611.074	3.300.611.084	3.300.611.381
187 ... 264	3.300.611.075	3.300.611.085	
360 ... 440	3.300.611.079	3.300.611.089	

- 1 Tin plated push on connector \varnothing 1.5 [0.059"]
- 2 Tin plated round pin \varnothing 1.5 [0.059"]

Time Preset Counters – HVa 15

Dv HVa 15.31

(knob locking cover)

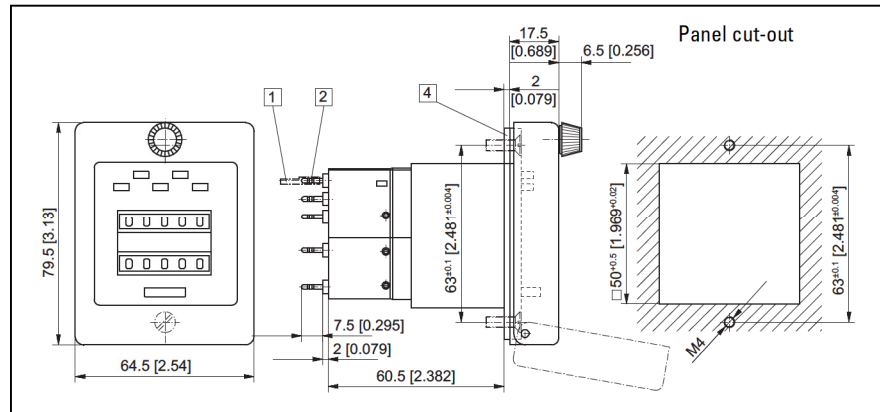

Voltage	Art-No. (AC), 50 Hz	Art-No. (AC), 60 Hz	Art-No. (V DC)
10 ... 30			3.300.711.351
20 ... 30	3.300.711.071	3.300.711.081	
36 ... 80			3.300.711.353
42 ... 48	3.300.711.072	3.300.711.082	
100 ... 130	3.300.711.074	3.300.711.084	3.300.711.381
187 ... 264	3.300.711.075	3.300.711.085	
360 ... 440	3.300.711.079	3.300.711.089	

- 1 Tin plated push on connector \varnothing 1.5 [0.059"]
- 2 Tin plated round pin \varnothing 1.5 [0.059"]
- 4 Gasket

Dvs HVa 15.31

(locking transparent cover)

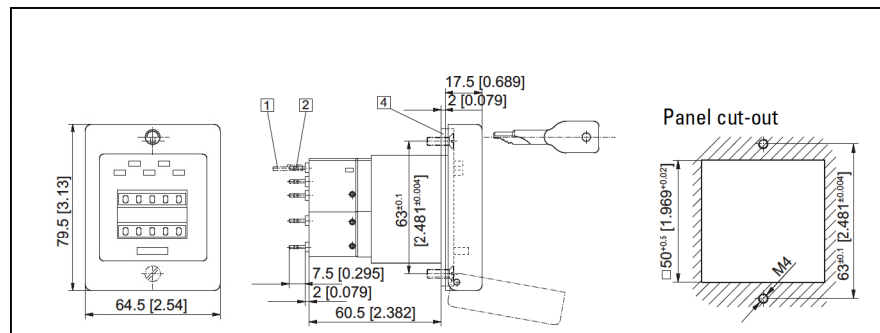

Voltage	Art-No. (AC), 50 Hz	Art-No. (AC), 60 Hz	Art-No. (V DC)
10 ... 30			3.300.811.351
20 ... 30	3.300.811.071	3.300.811.081	
36 ... 80			3.300.811.353
42 ... 48	3.300.811.072	3.300.811.082	
100 ... 130	3.300.811.074	3.300.811.084	3.300.811.381
187 ... 264	3.300.811.075	3.300.811.085	
360 ... 440	3.300.811.079	3.300.811.089	

- 1 Tin plated push on connector \varnothing 1.5 [0.059"]
- 2 Tin plated round pin \varnothing 1.5 [0.059"]
- 4 Gasket

Wiring diagrams:

